

ORBIC / Surface Mounted, Pendant Luminaire

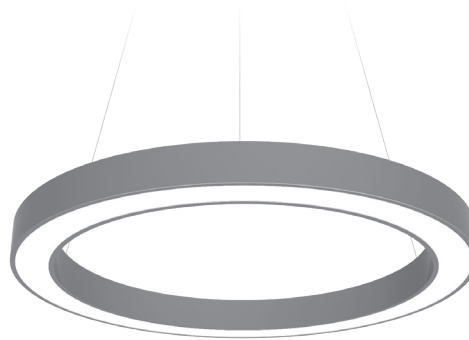
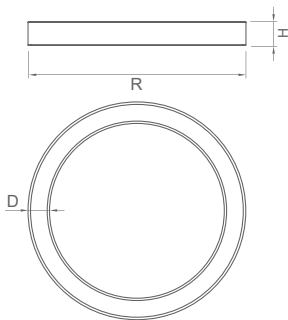

✓ Regular Feature

- Extruded Aluminium Body
- High Diffusion Diffuser
- MacAdam 3 Steps Colour Tolerance
- High Performance LED
- High Power Factor, Low TDH Driver

❓ Optional Feature

- Colour Option According RAL Code
- Driver Brands on Demand
- DALI and Other DIM Driver Compability
- Emergency Kit
- Various Dimension According Project

According Project ;
Luminaire

- Dimension and diameter,
- Power consumption per meter can change.

- Width of D can be between 7-12 cm.
- Longer than 200 mm diameter Diffuser can be several part and mounted during installation.

Please call for detail.

Power	Luminaire Luminous Flux (lm)*	Luminaire Efficiency	CRI (Ra)	Beam Angle	Dimensions (mm)		
					R	D	H
58W	6090	~ 105lm/W*	>80	120 °	900	80	70

Light Colour Options



* Efficiency based On 4000K Samsung 2835 LED.

- Standard Suspension Kit Length is 1.5mt.

🎨 Regular Frame Colour

- RAL 9003 Mat White
- RAL 9005 Mat Black
- Colour option with RAL code are available.

Turkey
Discover the potential

