

# ZEN M / Linear Surface Mounted, Pendant Luminaire

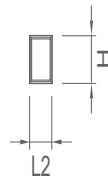

Various Colour With RAL Code

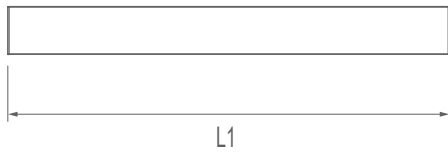

## ✓ Regular Feature

- Extruded Aluminium Body
- High Diffusion And Transmission Diffuser
- MacAdam 3 Steps Colour Tolerance
- High Performance LED
- High Power Factor, Low TDH Driver

## ? Optional Feature

- DDP and Other Diffuser Option
- Colour Option According RAL Code
- DALI and Other DIM Driver Compability
- Emergency Kit
- Driver Brands on Demand

Accordinging Project ;  
Luminaire

- Dimension and length,
- Power consumption per meter can change.

Sample dimensions for Profile (HxL2) ;

- 47x68mm • 52x82mm
- 55x75mm • 65x85mm
- 75x84mm • 78x100mm

Please call for detail.

## Luminaire

Power Consumption	42W/mt
Input Current	350mA Constant Current
Input Voltage	220 Ac
Luminaire Efficiency	~ 105lm/W*
CRI (Ra)	>80
Beam Angle	120 °

Light Colour Options



\* Efficiency based On 4000K Samsung 2835 LED.. • Standard Suspension Kit Length is 1.5mt.

## Regular Frame Colour

- RAL 9003 Mat White
- RAL 9005 Mat Black
- Colour option with RAL code are available.

**Turkey**  
Discover  
the potential

